



Tempe Elementary School District

**Gililand Middle School
Adjacent Ways Proposal
06/17/2022**



Exhibit B - Schedule of Values (Adjacent Ways)

Tempe Unified School District #3

Gililand Middle School Rebuild

June 17th, 2022

Div.	Description	GMP
1B	Survey & Layout	13,500
2A	Demolition	28,093
3A	Concrete	412,367
26A	Electrical (Offsite)	59,568
31A	Earthwork	664,409
33A	Site Utilities	194,179
	Testing & Special Inspections	15,000
	General Conditions	141,670
	Project Contingency	45,835
	Project / Design / Escalation Contingency	27,501
	Liability Insurance	22,001
	Builders Risk Insurance	11,000
	Payment & Performance Bond	20,167
	Gross Receipts Tax	96,529
	Fee	81,587
	TOTAL CONSTRUCTION COSTS:	1,833,406

Exhibit A.1 - Adjacent Ways Estimate Detail

Tempe Unified School District #3

Gililand Middle School Rebuild

June 17th, 2022

DIV	DESCRIPTION	ADJACENT WAYS QUANTITY	UNIT	TOTAL COST	DIVISION SUM
1B	Survey & Layout (Phase 01)				
	<u>Site Survey</u>				
	Establish Benchmark	20	Hours	1,800	
	Mass Grading & Limits	20	Hours	1,800	
	Asphalt & Curbs	80	Hours	7,200	
	<u>Misc. Survey</u>				
	Locating Services	1	LS	2,340	
	Total Survey & Layout				13,500
2A	Demolition				
	<u>Site Demolition</u>				
	Demo Asphalt	2,500	SF	7,500	
	Demo Hardscape	500	SF	1,500	
	U.G. Demo	1	LS	12,000	
	Safe-Off for U.G. & Bldg. Demo	1	LS	5,993	
	Demolition Debris Removal	2	Loads	1,100	
	Total Demolition				28,093
3A	Concrete				
	<u>Site Concrete</u>				
	Curb + Gutter (MAG Std Dtl 220-1, Type A)	2,699	LF	81,368	
	Single Curb (MAG Std Dtl 222, Type A)	2,941	LF	82,348	
	Sidewalk (MAG Std Dtl 230)	20,111	SF	100,722	
	Sidewalk ramps (2 per drive entrance)	4	EA	14,000	
	Driveway Entrance (COT Dtl T-320)	1,837	SF	27,966	
	7" thick concrete pavement (MAG AA concrete)	9,272	SF	86,079	
	Valley Gutter (Mag Std Dtl 240)	225	LF	7,200	
	Light Pole Base - Beck Ave	3	EA	7,500	
	Roll Curb (not keynoted)	108	LF	5,184	
	Total Concrete				412,367
26A	Electrical				
	<u>Site Electrical</u>				
	Street Lights - Offsite (6/29 email)	3	EA	59,568	
	Total Electrical				59,568
31A	Earthwork				
	<u>Grading</u>				
	Mobilization, Mass Grading	2	EA	14,000	
	Clear & Grub		Acres		
	Cut/Fill Operations	1,500	CY/ALLO	33,000	
	Mobilization, Fine Grading	2	EA	13,000	
	Fine Grading	98,873	SF	87,008	
	Temp Fire Lane, 4"ABC	2,000	SY	7,500	
	Mobilization, Asphalt Pavement	4	EA	18,000	
	Asphalt: 3" AC over 8" ABC	7,640	SY	305,600	

Exhibit A.1 - Adjacent Ways Estimate Detail

Tempe Unified School District #3

Gililand Middle School Rebuild

June 17th, 2022

DIV	DESCRIPTION	ADJACENT WAYS QUANTITY	UNIT	TOTAL COST	DIVISION SUM
	Sawcut, R&R 2' of existing asphalt (COT Dtl 316)	264	SY	27,720	
	Temporary Retention Basin	1,500	SF	7,200	
	Slurry Seal (MAG 332)	500	SY	11,000	
	<u>Striping & Signage</u>				
	Red Curb	5,545	LF	16,635	
	Parking Space, Striping	50	EA	5,000	
	<u>Misc. Earthwork</u>				
	Traffic Control, Barricades	8	Weeks	29,440	
	U.G. Demolition & Site additional site U.G Survey	1	LS	26,745	
	Dust Control Permit	1	LS	1,560	
	Water Mover / setup Temp Hydrant	250	LF	7,500	
	Dust Control, 4,000 Gallon Water Truck	4	Months	22,000	
	Dust Control, Water Truck Driver	240	Hours	13,200	
	Street Sweeping	8	Weeks	15,000	
	Construction Water	6	Months	3,300	
	Total Earthwork				664,409
33A	Site Utilities				
	<u>Domestic Water</u>				
	Coordinate w/ COT Water Dept for removal of existing water meter + service	1	EA	5,000	
	Install new 2" Landscape water service + meter w/ meter box and cover	6	EA	23,100	
	2" RPBFP (COT Std Dtl T-213)	5	EA	19,250	
	Install new 2" domestic water service + meter w/ meter box and cover	4	EA	19,400	
	Install 4" PVC Schedule 40 water line	18	LF	1,944	
	04C - 3" Gate Valve w/ VB&C	2	EA	7,700	
	Install new 2" reduced pressure backflow preventer	5	EA	19,250	
	8" Water Line	45	LF	4,860	
	8"x8" Tapping sleeve and 8" gate valve with VB&C	1	EA	3,500	
	Concrete encase existing sewer line	32	LF	6,400	
	Ex. 3" Domestic Water Meter and Vault to be removed	1	EA	3,500	
	<u>Sewer</u>				
	Connect to building sewer line	1	EA	2,500	
	Construct sewer building connection (MAG Std Dtl 440-1, Type A)	1	EA	4,800	
	Install 4" PVC SDR-35 sewer line	30	LF	2,940	
	Install 5' diameter sewer manhole w/ 30" frame + cover	2	EA	13,000	
	Install 8" PVC SDR-35 sewer line	12	LF	1,536	
	8" VCP Sewer Line	13	LF	1,664	
	<u>Flood Irrigation</u>				
	15" Irrigation line	45	LF	4,185	
	Tie into existing Water	1	EA	2,850	
	<u>Misc. Site Utilities</u>				
	Vertically realign water line to go beneath sewer line	6	EA	46,800	
	Total Site Utilities				194,179

Address: 10000 S Beck Ave, Glendale, AZ 85143
Project: GILLILLAND MIDDLE SCHOOL NEW CONSTRUCTION
Date: 11/10/2021
Drawn by: AS101

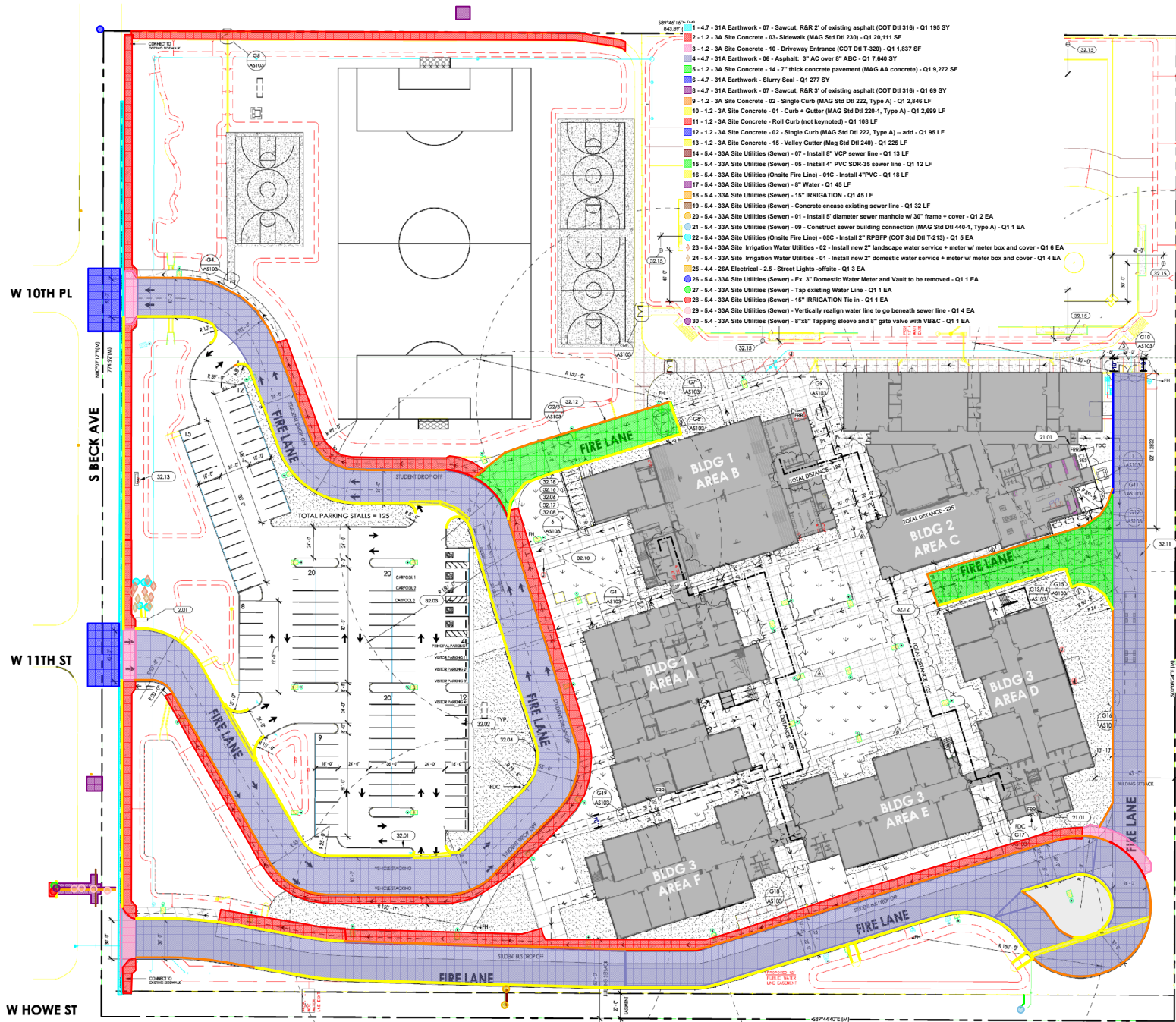

- ### KEY NOTES
- 01.01 EXISTING HARDWARE TO BE RELOCATED. PROTECT FROM DAMAGE DURING REMOVAL. SEE ARCHITECTURAL SITE PLAN FOR NEW LOCATION.
 - 01.02 FIRE HYDRANT.
 - 01.03 NEW 4" VERTICAL CURB. REFER TO CIVIL PLANS & DETAILS.
 - 01.04 NEW PARKING STALLS. REFER TO CITY OF TEMPE REQUIREMENTS.
 - 01.05 NEW HANDICAP PARKING STALL. STALL PAINTING & SIGNAGE PER CITY OF TEMPE REQUIREMENTS.
 - 01.06 PREVENT FILL AND CURB PAINTING. STRUCTURING AND SIGNAGE PER CITY OF TEMPE.
 - 01.07 NEW WROUGHT IRON FENCING - COLOR TO BE DETERMINED.
 - 01.08 NEW WROUGHT IRON MAIN GATE.
 - 01.09 NEW FLAG POLE.
 - 01.10 ASPHALT FIRE LANE DRIVE.
 - 01.11 CONCRETE FIRE LANE DRIVE.
 - 01.12 EXISTING HARDWARE TO BE RELOCATED.
 - 01.13 CHAIN LINK FENCE & PROPERTY LINE. REFER TO LANDSCAPE FOR DETAILS.
 - 01.14 MUSCO FIELD LIGHT. REFER TO ELECTRICAL PLANS/SPEC. FOR MORE INFO. REFER TO STRUCTURAL FOR POLE FOUNDATION.
 - 01.15 BMS BACK. SEE LANDSCAPE DWGS.
 - 01.16 SKATEBOARD RACK. SEE LANDSCAPE DWGS.
 - 01.17 CONCRETE HEADER. SEE LANDSCAPE DWGS.
- ### SITE HATCHES & SYMBOLS
- ▲ FDC
 - ⊕ FIRE HYDRANT
 - FLAG POLE
 - WROUGHT IRON FENCING
 - FIRE LANE (ASPHALT)
 - FIRE LANE (CONCRETE)
 - CONCRETE PAVING
 - MAGNARY PROPERTY LINE (PL)
 - PEDESTRIAN CROSSING PATH TO PUBLIC WAY
 - TRAVEL PATH TO PLUMBING FIXTURE

1 SITE PLAN - OVERALL

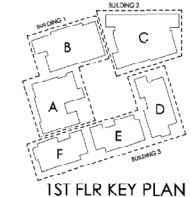

SPS+ ARCHITECTS

1025 S BECK AVE, TEMPE, AZ 85281

OVERALL SITE PLAN

THE DRAWING IS AN INSTRUMENT OF SERVICE & THE PROPERTY OF SPS+ ARCHITECTS. IT IS TO BE USED ONLY FOR THE PROJECT AND SITE SPECIFICALLY IDENTIFIED. IT IS NOT TO BE REPRODUCED OR REUSED IN ANY MANNER WITHOUT THE WRITTEN PERMISSION OF SPS+ ARCHITECTS.

DATE	DESCRIPTION
10/20/21	1.00 SITE PLAN
11/10/21	2.00 SITE PLAN
11/10/21	3.00 SITE PLAN
11/10/21	4.00 SITE PLAN
11/10/21	5.00 SITE PLAN

REVISION	DATE	DESCRIPTION
1	11/10/21	1.00 SITE PLAN
2	11/10/21	2.00 SITE PLAN
3	11/10/21	3.00 SITE PLAN
4	11/10/21	4.00 SITE PLAN
5	11/10/21	5.00 SITE PLAN

REVIEWED BY: ST
DRAWN BY: MD

DATE: 11/30/21
JOB NO: 21008
SHEET: AS101

21008

W Elna Rae St

W Elna Rae St

S Beck Ave

W 10th St

W 10th St

th Pl

S Beck Ave

th St

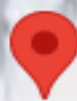

Gilliland Middle School

W Howe St

W Howe St

S Beck Ave

W 12th St

W 12th St

ed

Google

KEY NOTES

- EXISTING MARQUEE TO BE RELOCATED. PROTECT FROM DAMAGE DURING REMOVAL. SEE ARCHITECTURAL SITE PLAN FOR NEW LOCATION.
- FIRE RISER ROOM.
- NEW 6" VERTICAL CURB. REFER TO CIVIL PLANS & DETAILS.
- NEW PARKING STALL STRIPING PER CITY OF TEMPE REQUIREMENTS.
- NEW HANDICAP PARKING STALL - STALL PAINTING & SIGNAGE PER CITY OF TEMPE REQUIREMENTS.
- PROVIDE FIRE LANE CURB PAINTING, STENCILING AND SIGNAGE PER CITY OF TEMPE.
- NEW FLAG POLE
- ASPHALT FIRE LANE DRIVE
- CONCRETE FIRE LANE DRIVE
- EXISTING MARQUEE TO BE RELOCATED.
- CHAIN LINK FENCE @ PORPHYRY LINE. REFER TO LANDSCAPE FOR DETAILS

SITE HATCHES & SYMBOLS

- FDC
- FH FIRE HYDRANT
- FGL PL FLAG POLE
- WROUGHT IRON FENCING
- FIRE LANE (ASPHALT)
- FIRE LANE (CONCRETE)
- CONCRETE PAVING
- IMAGINARY PROPERTY LINE (IPL)
- PEDESTRIAN EGRESS PATH TO PUBLIC WAY ACCESSIBLE ROUTE
- TRAVEL PATH TO PLUMBING FIXTURE



SITE PLAN - OVERALL

1" = 30'-0"

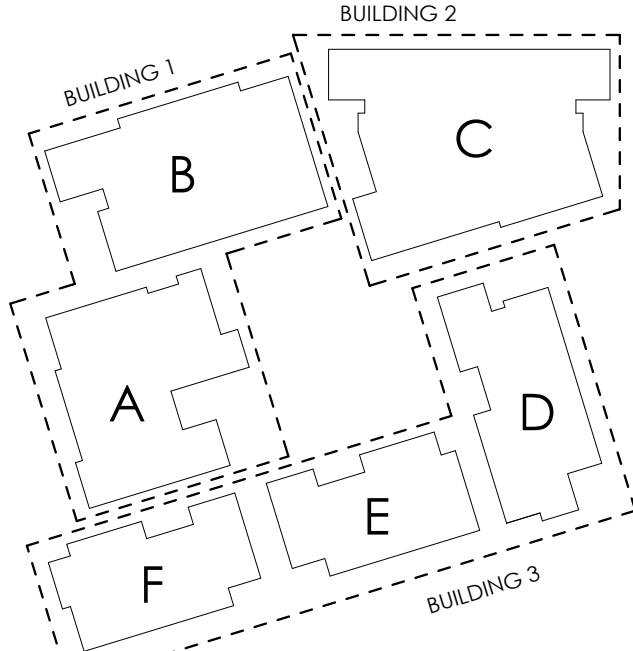
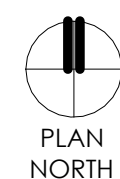

1ST FLR KEY PLAN